

Installation Guidelines

EASY-FUR™

A Rollable Furring Strip

Inspection of Wall Conditions and Weather Barrier/Building Wrap

Ensure that the wall is free from structural defects, any membranes or flashing are properly installed, and that the final system will have a path for moisture to escape from the wall. Keene Building Products' EASY-FUR™ should only be applied to structurally sound surfaces, which incorporate good building practices, and meet all local code requirements. Before starting any applications, check with your local building code requirements and read all manufacturers' installation instructions.

Installation Guide for Siding, Fiber-Cement and Wood Siding

1. Install building paper or WRB* and flashing according to manufacturers' recommendations.
2. **(Diagram 1)**
Installations over ½" OSB or plywood intended for wood or cement cladding, place EASY-FUR over building paper or WRB* aligning with the wall studs at 16" on center. Place dimples against the building paper and WRB*. Secure EASY-FUR in place with staples, nails, screws, or other approved fasteners capable of penetrating the wood sheathing or metal studs. Start at the top of the wall and work down.
For wood sheathing: staples are to be a minimum of ½" in length. For exterior gypsum: screws are to penetrate stud a minimum of 1/4". For further fastening questions please contact Keene Building Products representative.
3. **(Diagram 2)**
Installations over 1" insulation and ½" OSB or plywood intended for wood or cement cladding, place EASY-FUR over building paper or WRB* aligning with the wall studs at 16" on center. Place dimples against the building paper and WRB*. Secure EASY-FUR in place with 6d nails with ½" cap at 16" on center. Start at the top of the wall and work down.

Windows & Trim

1. Secure additional EASY-FUR behind corner trim, and vertical window trim. Attach EASY-FUR 1" away from window frame for air and water channel behind trim.
2. Place EASY-FUR along both the top and bottom length of the window. EASY-FUR will act as a screen to provide venting and deter possible insects or wind driven debris.
3. Trim windows and doors as specified by manufacturer.

WRB* = Water-Resistive Barrier

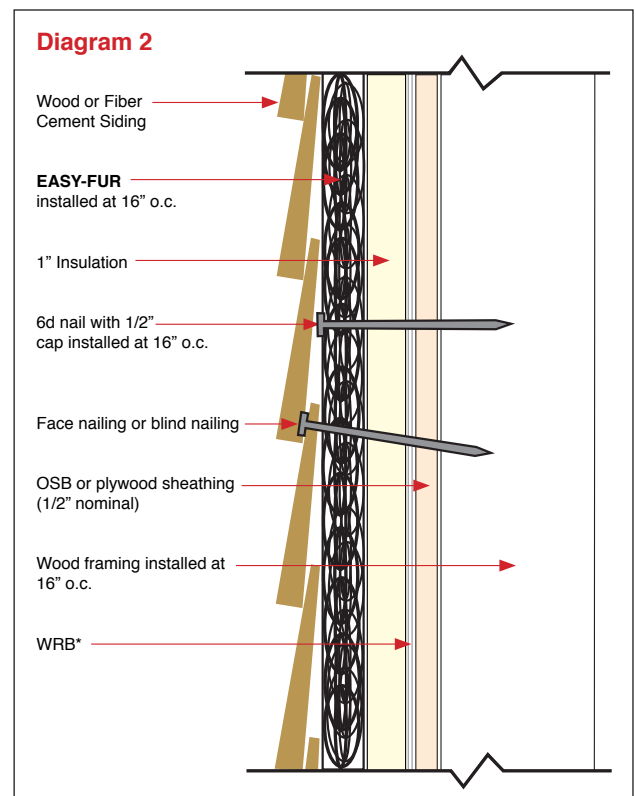
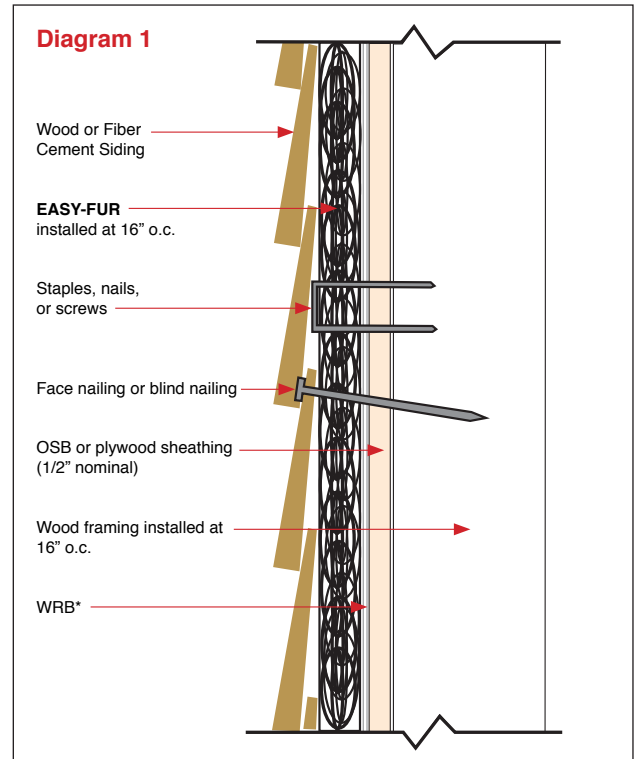

Base of Wall

1. Run EASY-FUR horizontally at the base of wall. EASY-FUR will act as a screen to provide venting and deter possible insects or wind driven debris.
2. Snap a line 4" above the bottom edge of the siding.
3. Secure length of a EASY-FUR to base of wall running horizontally, along the top of the line.
4. When applying lap siding, place a second EASY-FUR over the first. This second layer is a furring layer to give the siding proper slope for the bottom course. Siding should overlap the entire base assembly by ½".

Top of Wall

1. Run EASY-FUR horizontally at the top of wall. EASY-FUR will act as a screen to provide venting and deter possible insects or wind driven debris.